

Advice for correct fitting of the kit : Do not fully tighten the bolt until it's ensured that the KIT is correctly attached and aligned.

Cara pasang yang benar : Jangan sepenuhnya kencangkan baut sampai dipastikan bahwa KIT terpasang dengan benar dan selaras.

INSTRUCTION TO COMBINE WITH TOP FITTING KITS



Install and adjust position of part No.2 with clamp.



Install part No.11&12 in to part No.1 then Install part No.1 and choose few holes to assy with part No.5.



Install part No.3 to part No.1 by choose one of holes in Part No.3 , then install with part No.7/No.8.



Release hinge and wire from footstep,then choose one of holes in Part No.3 and install with part No.4 and Part No.6



Adjust left and right position according to motorbike body then fully tighten.



Put white marks in to left and right then uninstall the clamp. Drill Top Kits body with diameter 12mm(outside) and 9mm(inside)



Install part No.9 in to each holes and install part No.6



Once kit is securely installed on the right & left portion of the unit, tighten all bolts. After that Install side cases properly

Advice for correct fitting of the kit : Do not fully tighten the bolt until it's ensured that the KIT is correctly attached and aligned.

Cara pasang yang benar : Jangan sepenuhnya kencangkan baut sampai dipastikan bahwa KIT terpasang dengan benar dan selaras.

INSTRUCTION TO INSTALL ONLY 3P KIT UNIVERSAL



Make additional metal part to attach and connect between Part No.2 and frame motorbike



Install part No.11&12 in to part No.1 then Install part No.1 and choose few holes to assy with part No.5.



Install part No.3 to part No.1 by choose one of holes in Part No.3 , then install with part No.7/No.8.

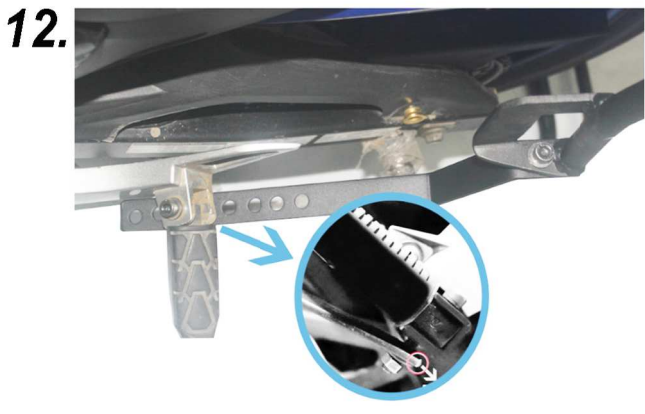

Release hinge and wire from footstep, then choose one of holes in Part No.3 and install with part No.4 and Part No.6



Once kit is securely installed on the right & left portion of the unit, tighten all bolts. After that Install side cases properly

SIDE BRACKET UNIVERSAL
3P KIT MASTER
U0UN14IF

COMPONENTS / PARTS :

Pos	Cant.	Pos	Cant.
1	2 Pcs Universal Bracket No.1	7	2 Set Bolt M8xL55 + Nut M8 + 2 Ring Plat
2	2 Pcs Universal Bracket No.2	8	2 Set Bolt M6xL50 + Nut M6 + 2 Ring Plat
3	2 Pcs Universal Bracket No.3	9	4 Pcs Ring Boss
4	4 Set Bolt M8xL35 + Nut M8 + 2 Ring Plat + 1 Ring Per	10	2 Pcs Bussing
5	4 Set Bolt M8xL25 + Nut M8 + 2 Ring Plat + 1 Ring Per	11	2 Pcs Plug Universal SH36
6	2 Set Bolt M8xL25 + Nut M8 + 2 Ring Plat	12	2 Pcs Screw M4xL20